

01 FOUNTAIN SECTION  
F.5.2 SCALE: 3/4" = 1'-0"

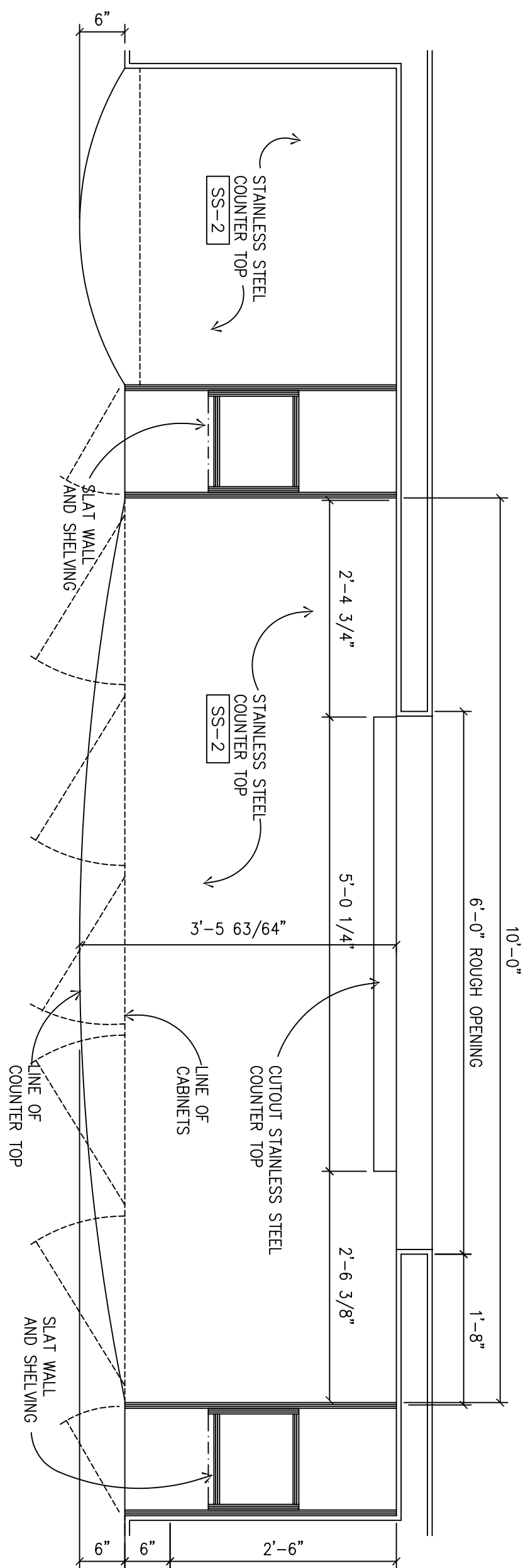

02 FOUNTAIN SECTION  
F.5.2 SCALE: 3/4" = 1'-0"

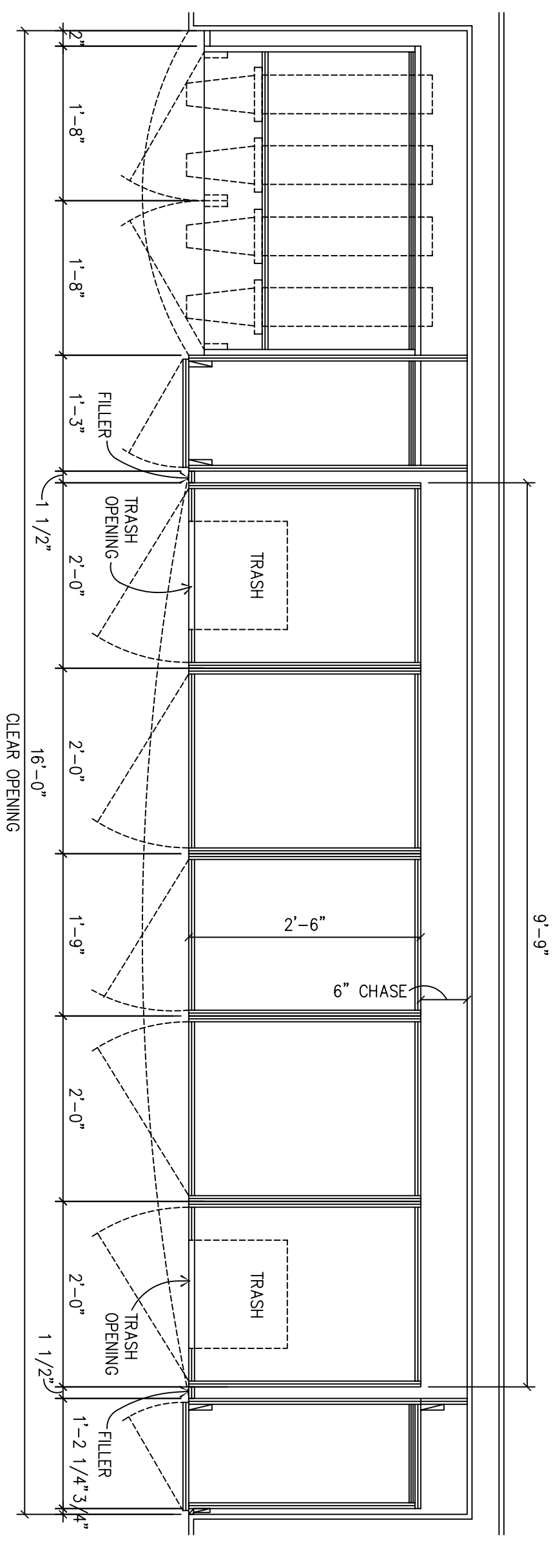

03 FOUNTAIN SECTION  
F.5.2 SCALE: 3/4" = 1'-0"

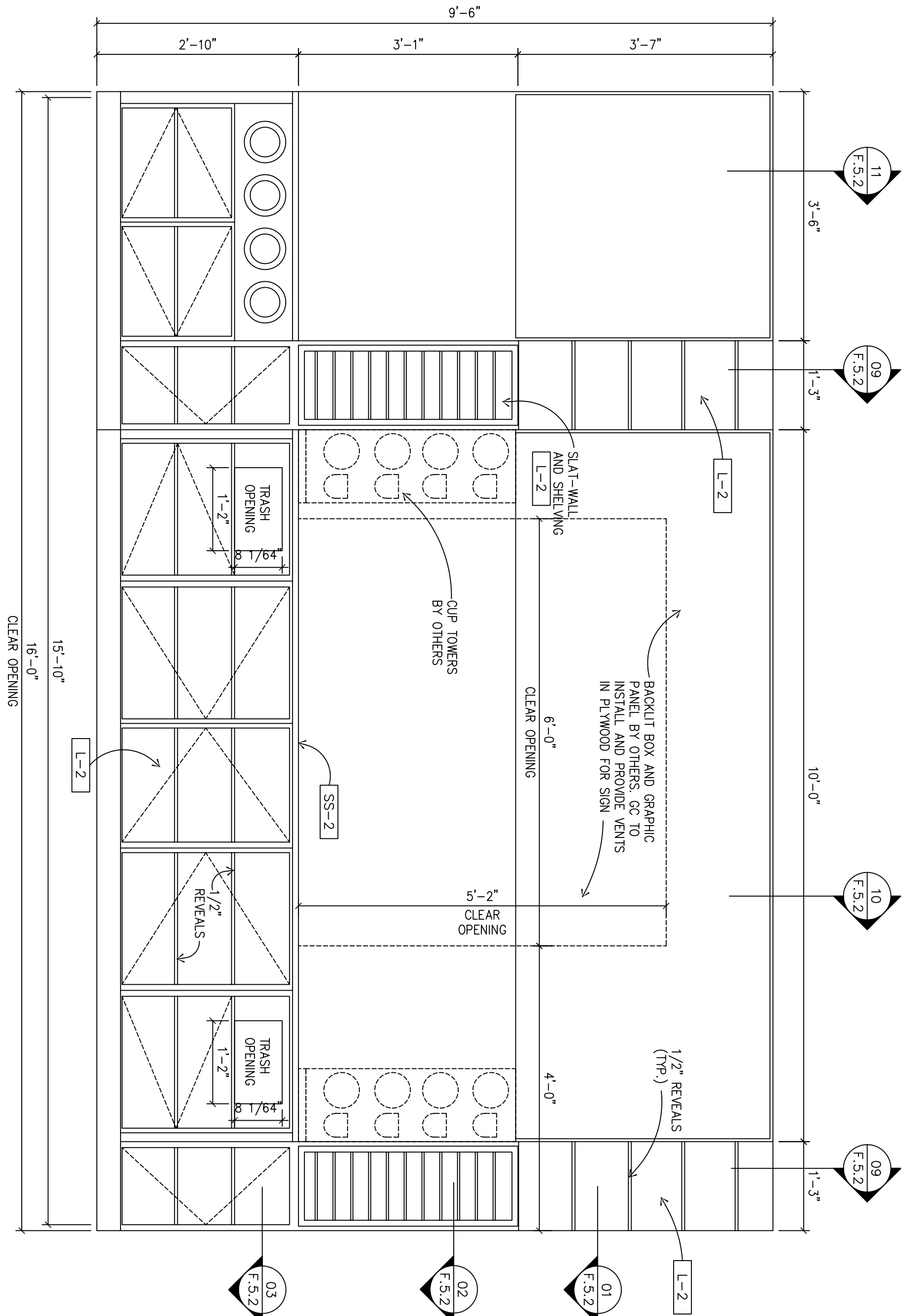

05 FOUNTAIN ELEVATION  
F.5.2 SCALE: 3/4" = 1'-0"

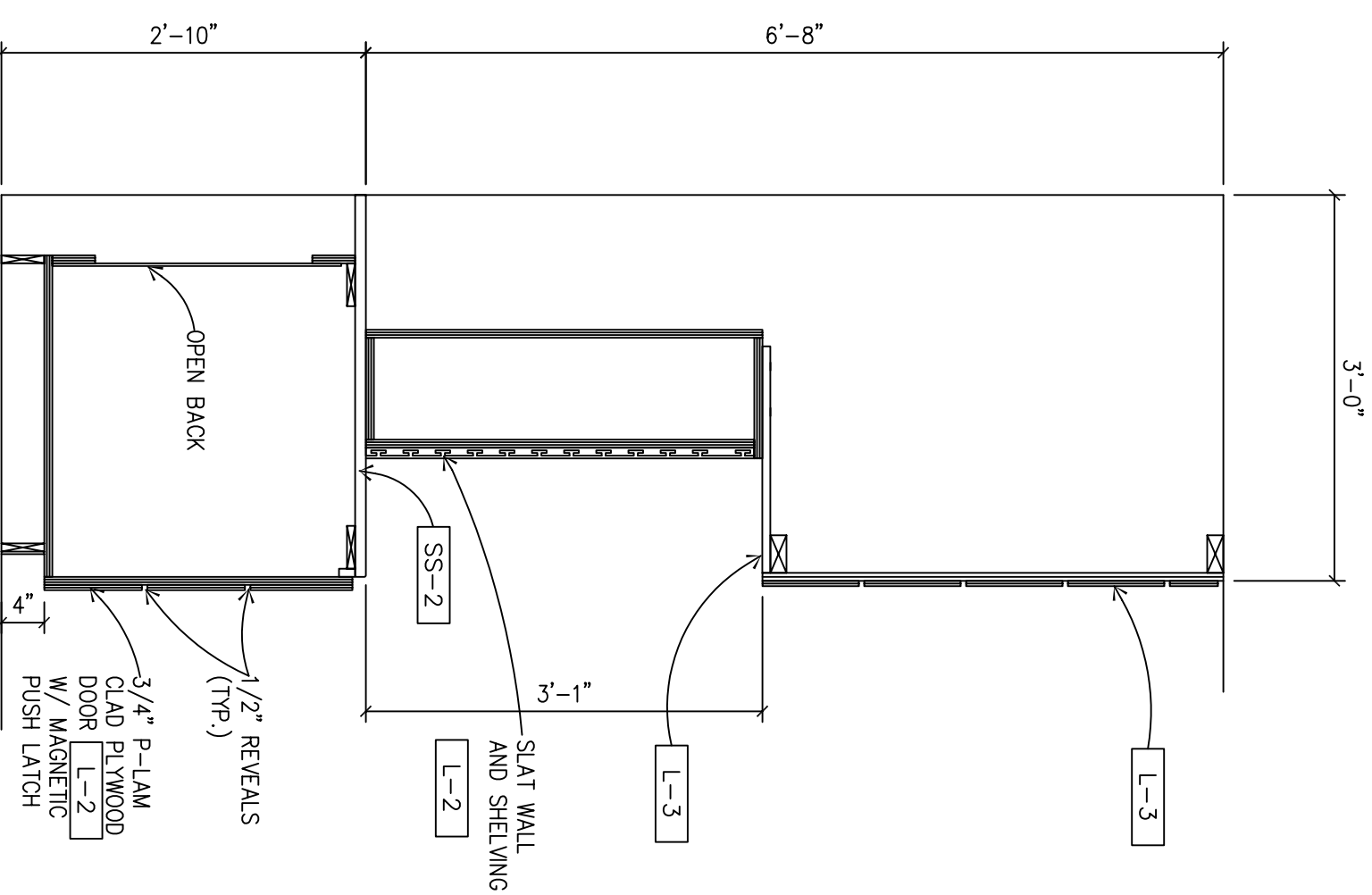

09 FOUNTAIN SECTION  
F.5.2 SCALE: 3/4" = 1'-0"

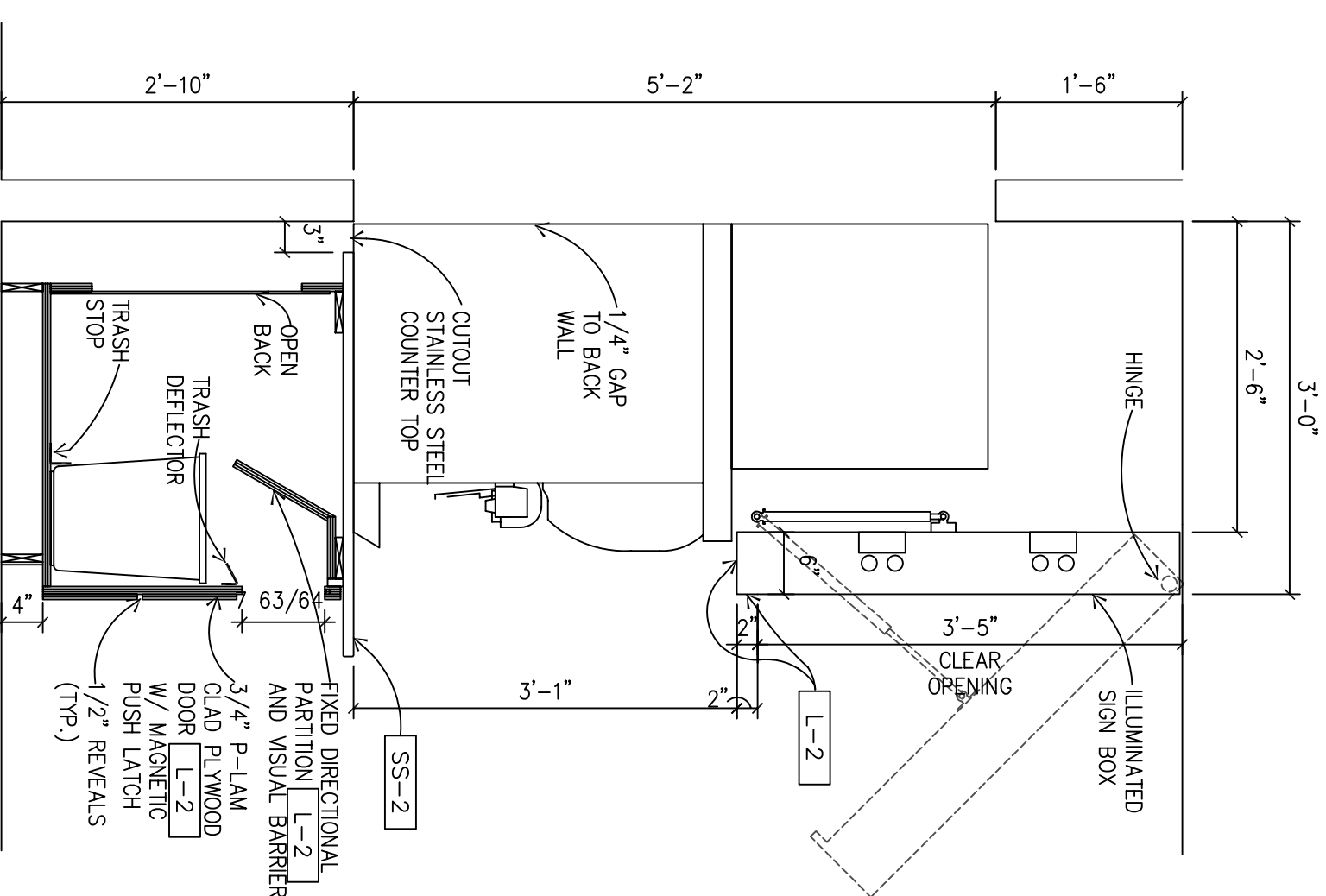

10 FOUNTAIN SECTION  
F.5.2 SCALE: 3/4" = 1'-0"

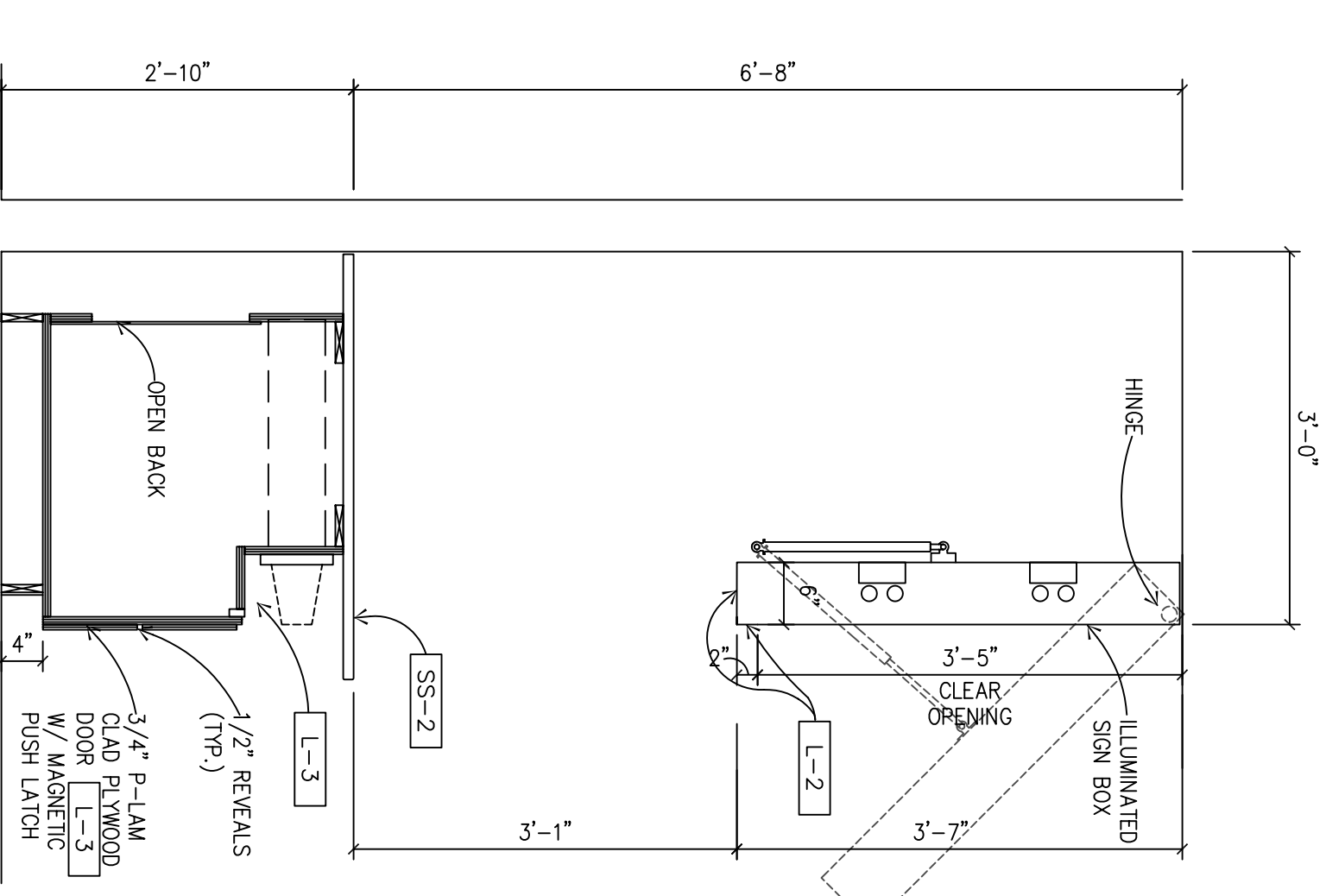

11 FOUNTAIN SECTION  
F.5.2 SCALE: 3/4" = 1'-0"

**NOTES:**  
FIELD VERIFY DIMENSIONS PRIOR TO FABRICATION.  
ALL HINGES TO BE CONCEALED HEAVY DUTY TYPE

**LAMINATES**

- SS-1 COUNTER TOP- GIBBALTER "BOGE TEMPEST" (1530-1M)  
BY: WILSONART
- SS-2 USE 0.125" SOLID SURFACE LAMINATE AT PAINTPOINTS
- L-1 COUNTER TOP- 18 GAUGE STAINLESS STEEL  
BY: WILSONART
- L-2 WOOD LAMINATE- "FUSION MAPLE" (7909-40)  
BY: WILSONART
- L-3 METAL LAMINATE- "GREY" WITH CUSTOM FINISH (092,80)  
BY: WILSONART
- L-4 COLOR LAMINATE- "BLUE" (1025)  
BY: ABBETT LAMINATE



PRINCE REAL ESTATE HOLDINGS INC.  
RIVERSIDE COUNTY TRAVEL CENTER LLC  
COO & CO-OWNER

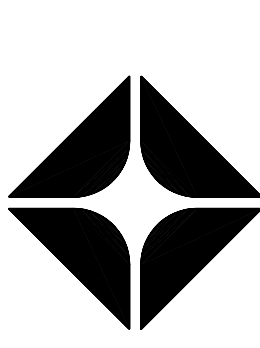

WEST COAST PRODUCTS LLC  
CONSULTANT:



733 N. MAIN ST.  
ORANGE, CA 92666  
714/ 769-2000  
714/ 769-2002 Fax  
WWW.WESTSTATES.COM  
A "Design/Build" Co.

NO.	DATE	REVISION DESCRIPTION
1	11-17-01	BUILDING SUBMITTAL
2	4-19-04	REVISED PER PLAN CHECKS
3	6-01-04	REVISED PER PLAN CHECKS
4	8-10-04	REVISED PER PLAN CHECKS
5	9-27-04	REVISED PER PLAN CHECKS & IN-CHARGE CORRECTIONS

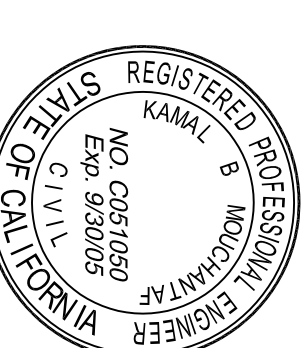

CONFERENTIALITY STATEMENT:  
THE SIGNATURE OF THIS INDIVIDUAL REPRESENTS THAT HE OR SHE HAS REVIEWED THE DRAWING AND IS AWARE OF THE CONTENTS THEREOF. THE SIGNATURE OF THIS INDIVIDUAL DOES NOT CONSTITUTE AN ENDORSEMENT OF THE PROJECT OR THE QUALITY OF THE WORK THEREON. THE SIGNATURE OF THIS INDIVIDUAL DOES NOT CONSTITUTE AN ENDORSEMENT OF THE PROJECT OR THE QUALITY OF THE WORK THEREON. THE SIGNATURE OF THIS INDIVIDUAL DOES NOT CONSTITUTE AN ENDORSEMENT OF THE PROJECT OR THE QUALITY OF THE WORK THEREON.

DEVELOPMENT INFORMATION:  
**NEW BUILD (STICK)**  
**3600 SERIES AM/PM**  
**CENTER CASHIER**  
**TO GO DELI**

SITE ADDRESS:  
**23261 CALALCO EXWY.**  
8 HARVEY AVENUE  
FERRIS, CALIFORNIA 92521

DESIGNED BY: ALIANCE STARK  
CHECKED BY: JIP REINE  
DRAWN BY: ALIANCE FINE  
VERSION: V01  
PROJECT NO: 11.17.03  
E75403

DRAWING TITLE:  
**BUILDING # 1**  
**FOUNTAIN COUNTER**  
**MILLWORK**

SHEET NO:  
**DOFO**  
**F.5.2**